

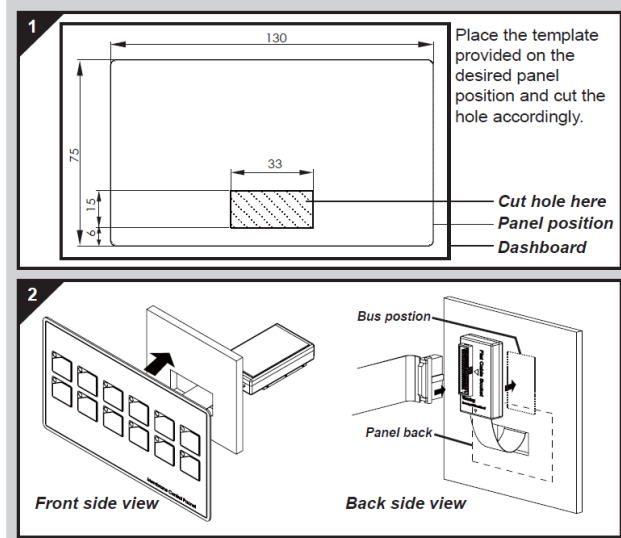

### Installation Instructions

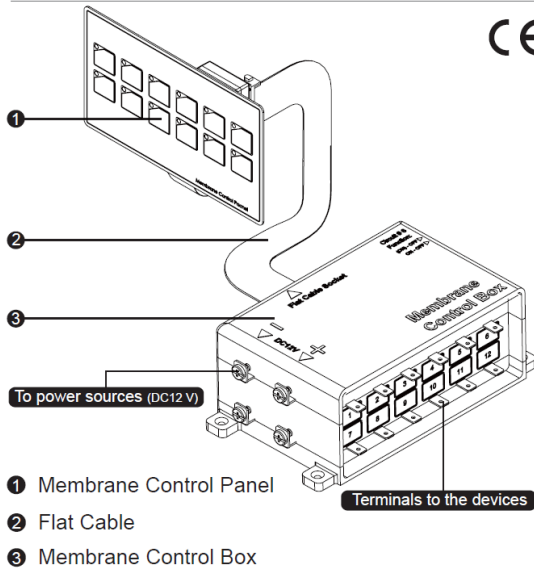

### Features

- Ultra compact panel size, 75% smaller than traditional switch panels of the same number of positions
- Easy to install; almost no mounting depth required
- Soft and flexible panel that suits even curved surface
- IP67-protected against temporary immersion in water
- Remotely installed control box (up to 1m away from the touch panel) provides maximum flexibility for wiring
- ON-indicating LED and 10A PPTC for each branch
- 40-pcs assorted label (texts and graphics) set included
- Branch #6 can be set to be momentary upon installation, ideal for "Horn" or other applications (SP5011 only)

### Specifications

- Faceplate | PET membrane touch panel
- Circuit Protection | Built-in Resettable Fuse (PPTC)
- Switch Ratings | 10A per branch @ DC 12V
- Panel Rating | Maximum Cumulative Amp: 35A x 2 (12P)
- Notes | IP67 (Membrane Panel)
- Power Terminals | #8 stud size Ring terminals
- Load Terminals | .250 Quick Terminals (Male)

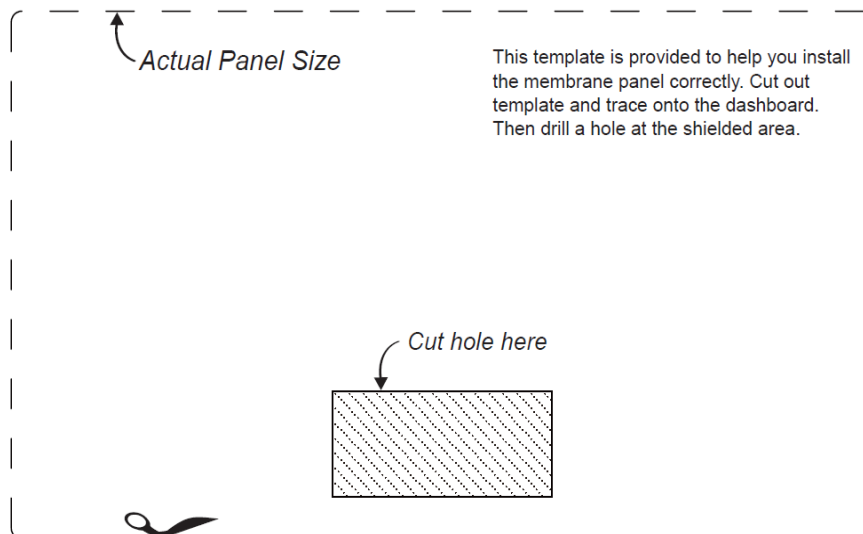
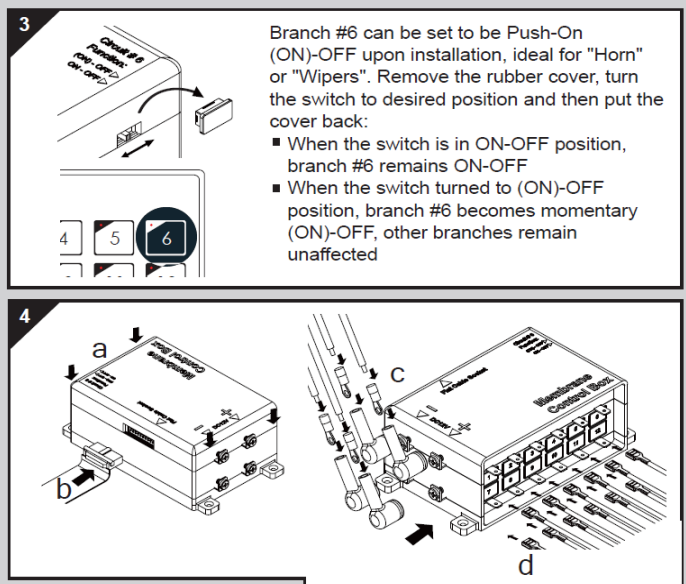

- Install the Control Box properly with the included screws.
- Connect the Control Box to the Touch Panel with the flat cable.
- Insert the power source wires into the included round terminals and crimp the terminals. Pass the wire through the included insulators (black & red) and connect to the screw terminals (screws included in package). Cover the terminals with the insulators properly.
- Connect the load terminals to the desired devices. The numbers on top of the load terminals correspond to the numbers on the membrane touch panel.